

2014+ Mercedes Benz/Freightliner Sprinter 3500 - DRW - 2-Stage Rear Air Suspension



Looking to improve the ride on the versatile Sprinter chassis?

Look no further than a Kelderman 2-Stage Rear Air Suspension. One of the most popular van chassis vehicles, the Sprinter chassis is used in many different industries and many users are searching for a way to improve the ride. Designed for long-distance travel and rough terrain, this air suspension system is perfect for those who love to travel. We replace all of the factory suspension components with a complete air ride setup that smooths out bumps and enhances comfort, stability, and control.



By attaching our unique 2-Stage Rear Air Suspension Framework to the rear leaf spring shackle to provide additional travel for the leaf springs, you will have an improved riding and driving experience in your Sprinter.

This kit is compatible only with the 3500 dual rear wheel, long-wheelbase (170") models. **Exhaust modification is required.**



Scan me!

2-Stage Design

Unique 2-Stage Rear Air Suspension Framework attaches to the rear leaf spring shackle to provide additional travel.

Smoother Ride

Bumps are absorbed by the air suspension rather than the stiff factory leaf springs for a more comfortable ride.

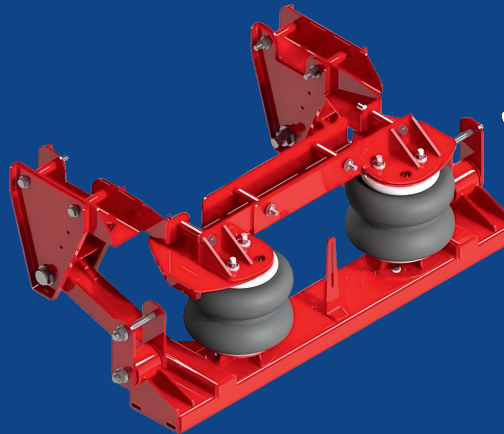

Tested

This proven design has been in production for over 25 years, and is engineered to provide you with the ride quality you deserve.

Additional Travel

Our suspension provides 3-4" of additional travel.



@Kelderman Trucks



@Kelderman Trucks



@keldermantrucks