

ITEM NO.	PART #	DESCRIPTION	QTY.
1	10016	20-22" Trailing Arm	2
2	10515	39" Trailing Arm	2
3	11684	Upper Bag Mount / Rear Crossmember (3" Rise)	1
4	10859	(PS) Side Plate	1
5	10860	(DS) Side Plate	1
6	11806	27.5" Pan Hard Bar	1
7	10882	Frame Mount	1
8	10211	TUBE - SHAFT SPACER (18mm)	2
9	14629	(PS) Lower Bag Mount / (PHB) Mount	1
10	14630	(DS) Lower Bag Mount (3.5" Axle)	1
11	10619	Axle Clamp w/ Shock Mount (3.5)	1
12	10621	Axle Clamp w/ Shock Mount (3.5")	1

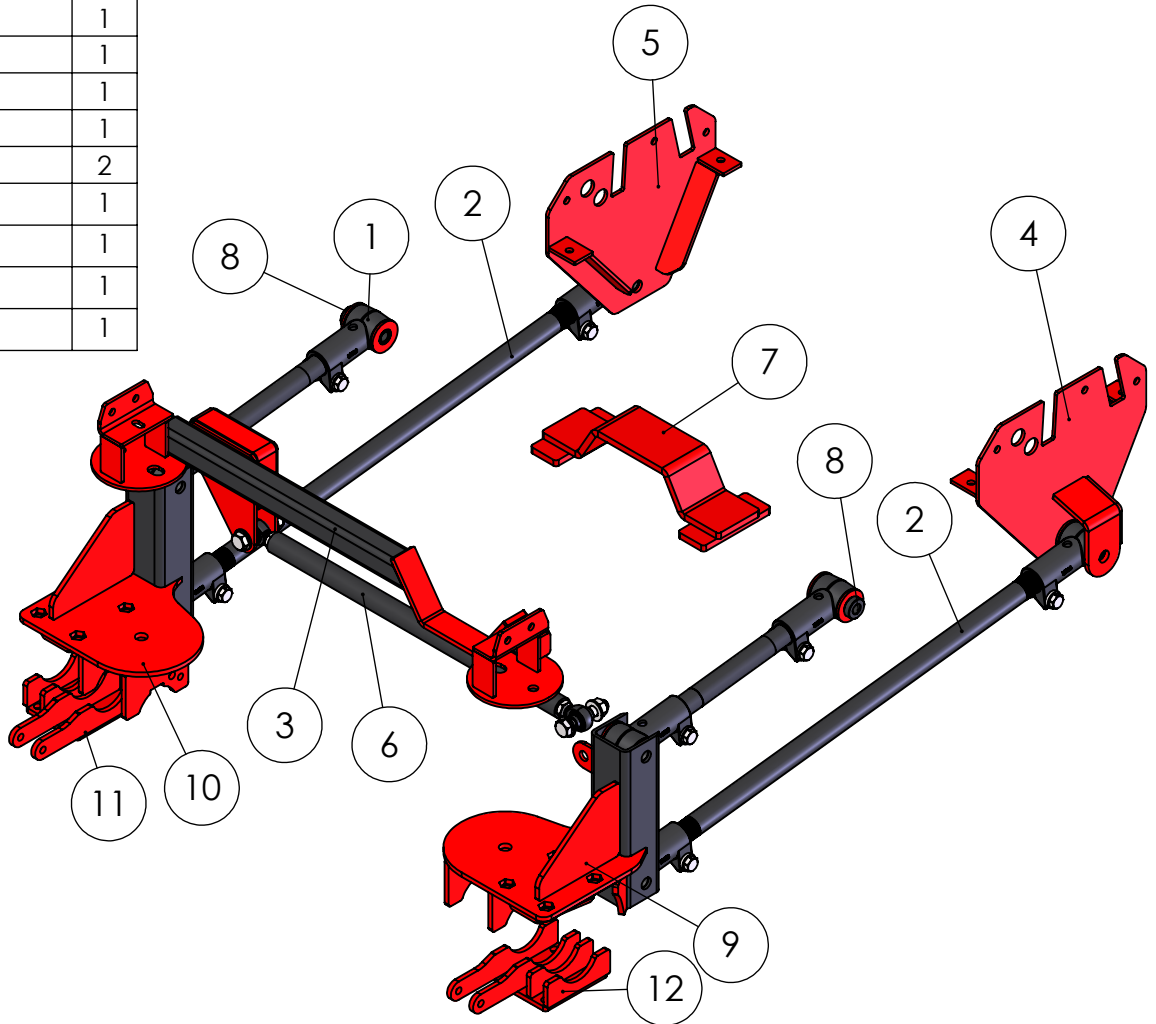

UNLESS OTHERWISE SPECIFIED: DIMENSIONS ARE IN INCHES TOLERANCES: FRACTIONAL: 1/32" ANGULAR: MACH ± 1 BEND ± 1 TWO PLACE DECIMAL ±.030 THREE PLACE DECIMAL ±.010 MATERIAL FINISH WEIGHT 252.3235	Design By: Zach Beltz 2014	Project: 1999-2005 Ford Excursion 4x4 7-8" Lift (Rear)
	Shelf # / Qty	Description: 4-Link Rear
	Inventory	SIZE DWG. NO. A 10858
	Run Qty:	SCALE: 1:50 DO NOT SCALE DRAWING SHEET 1 OF 2
PROPRIETARY AND CONFIDENTIAL THE INFORMATION CONTAINED IN THIS DRAWING IS THE SOLE PROPERTY OF KELDERMAN MFG. INC. ANY REPRODUCTION IN PART OR AS A WHOLE WITHOUT THE WRITTEN PERMISSION OF KELDERMAN MFG. INC. IS PROHIBITED.		

