



*kelderman*

**AIR SUSPENSION SYSTEMS**

**2686 Highway 92 - Oskaloosa, IA 52577**

**phone: 641.673.0468 - fax: 641.673.4168**

**www.kelderman.com**

# **2013+ Ram HD 4x4 Front Installation Instructions**



A 1/2-20 and 5/16-18 tap is required for install  
Welding is required

1. Jack up the truck and remove the tires. Place a jack stand under the frame rails and leave the jack under the axle.



2. Remove the wheels and shocks. Now let the axle down and remove the coil springs.



3. Locate the upper bag mounts (Part# 18265 DS and 18264 PS). Locate the hole in the upper in the coil bucket. Put the upper bag mount in position. You will have to drill one hole in the coil bucket, so with the bag mount in position mark the hole. Remove the bag mount and drill it out for the 3/8" bolt. Once the hole is drilled install the bag mount with the 3/8x1 1/2" bolts. Torque these bolts to 35 ft/lbs.



4. Locate the bottom air bag mounts (Part# 18269DS and 18274PS) and 5323 air bags. The lower bag mounts will fasten to the lower spring bucket with the 1/2x1" and 3/8x 1 1/2" bolts. The hole for the 3/8" bolt will have to be drilled and tapped for 3/8-24 bolt. The hole for the 1/2" bolt just needs to be tapped with a 1/2-20 tap. Set the lower bag mount in position and make your mark where to drill. Once you have the hole tapped and other hole drilled, fasten the 5323 air bag to the lower bag mount with the 1/2x3 1/2" bolts. Make sure to set the orientation of the bag first by test fitting it in the upper bag mount before torquing the bolt to 35 ft/lbs. Once the bag is lined up, torqued to the lower bag plate, fasten the lower bag mount to the spring bucket. Torque the 3/8" bolt to 35 ft/lbs and the 1/2" bolt to 55 ft/lbs. Now jack the axle up and fasten the top of the bags to the upper bag mount with the 1/2 and 3/4" nuts and washers. Torque each nut to 35 ft/lbs.



**Tap the drivers side front hole and passengers side rear hole  
Tap to 3/8-24 NPT**

5. Now that the air bags and brackets are installed locate the shocks (Part# 99043). Turn the dial on the bottom of the shock to setting 3. Setting 3 and 4 are where the ride quality is the best. They install on the top just the same as how the OEM shocks were mounted. The bottom, however, uses relocation brackets (Part# 18302). Use the 9/16x5" bolt to fasten the bracket and shock into the OEM lower shock bolt. Torque this bolt to 135 ft/lbs. NOTE: You will probably have to shave the head of the upper trailing arm bolt for needed clearance.

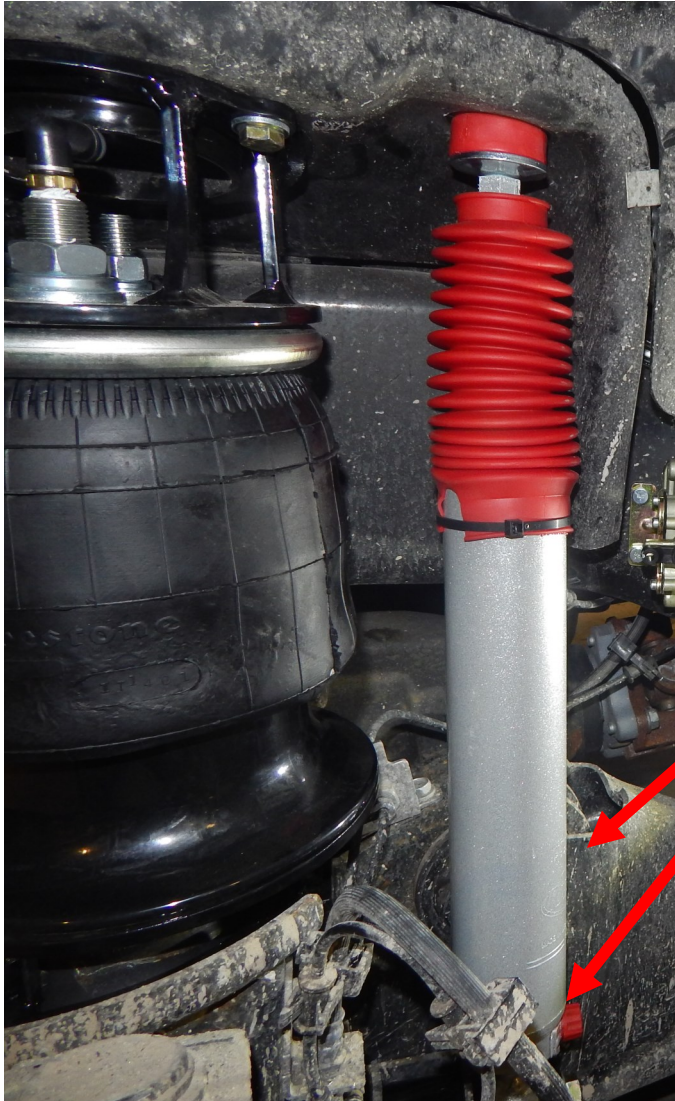

Check to see that the head of the trailing arm bolts are not rubbing on the inside of the shocks. The after market shocks are larger than the OEM shocks and can rub. If they are close you will need to grind the raised portion of the head off the bolt (approximately 1/16")



6. Locate the air fitting. Thread the fitting into the air port on the bag. Turn it finger tight then one complete turn after that. If the fitting doesn't already have thread sealer applied, use Teflon tap on the threads to prevent slow leaks.

7. If you are doing a manual fill system, decide where you want to mount the Schrader valves. Mount the fill valves and cut the correct length of air line and connect to the air fitting in the airbag. Inflate the bags. It works best to alternate between the left and right sides in attempt to get the bags with somewhat equal pressure. The smoothest ride will be when the air bags are between 7 1/2 and 8 1/2" tall. Typically the air pressure will be around 65-70 psi. Do not be alarmed if the bags are not the exact same pressure. They should be, however, with in 5 psi of each other at ride height.

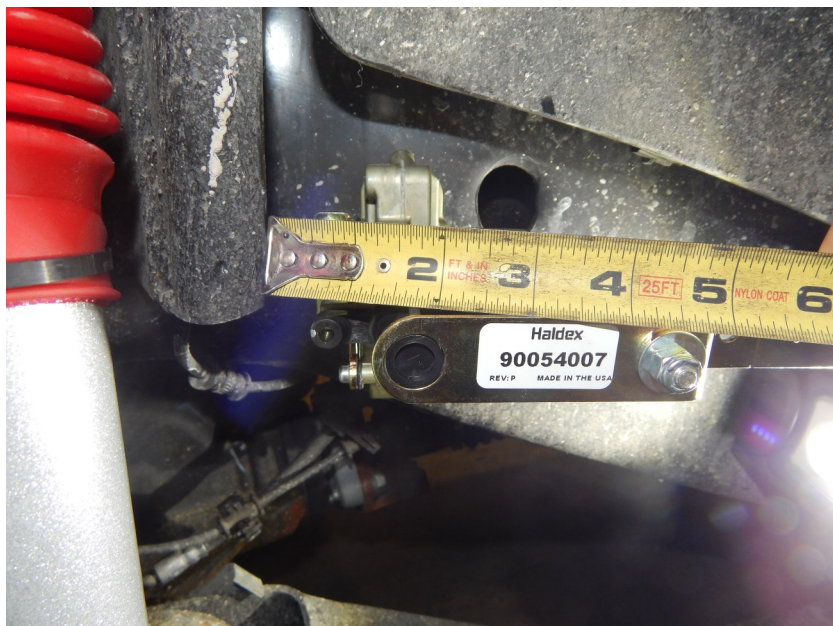

Mechanical height control valve shown

Drill and tap for the 5/16-18 thread and insert the ball for the endlink to mount to

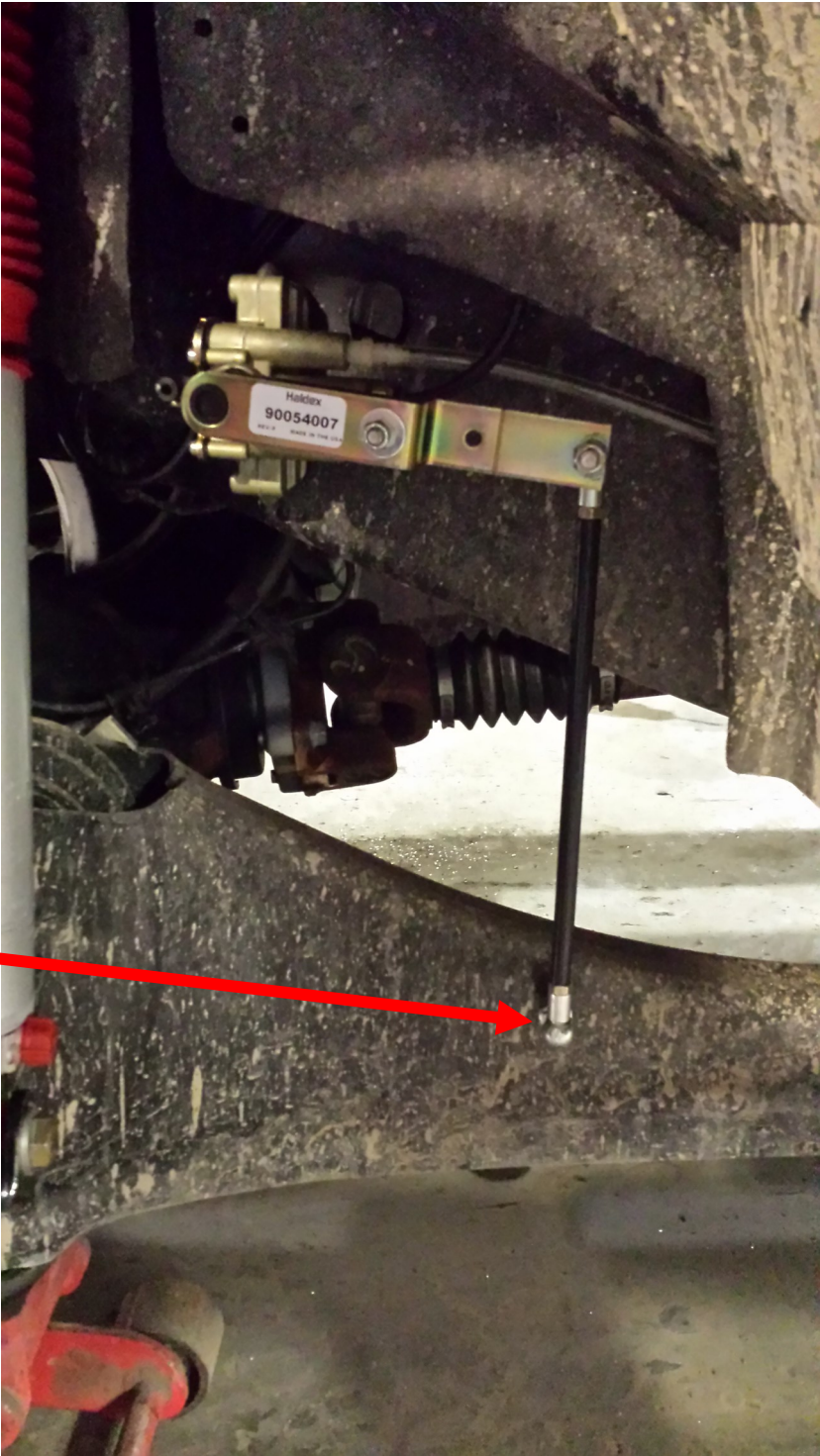

Locate the drivers side weld in gusset. It looks like a thick hockey stick. It gets welded the drivers side The passenger side has one installed from the factory but for some unknown reason the drivers side doesn't have one. Failure to weld the bracket in may result in the spring bucket bending upwards. NOTE: Use a battery protection device when welding or disconnect the batteries to prevent potential electronic damage

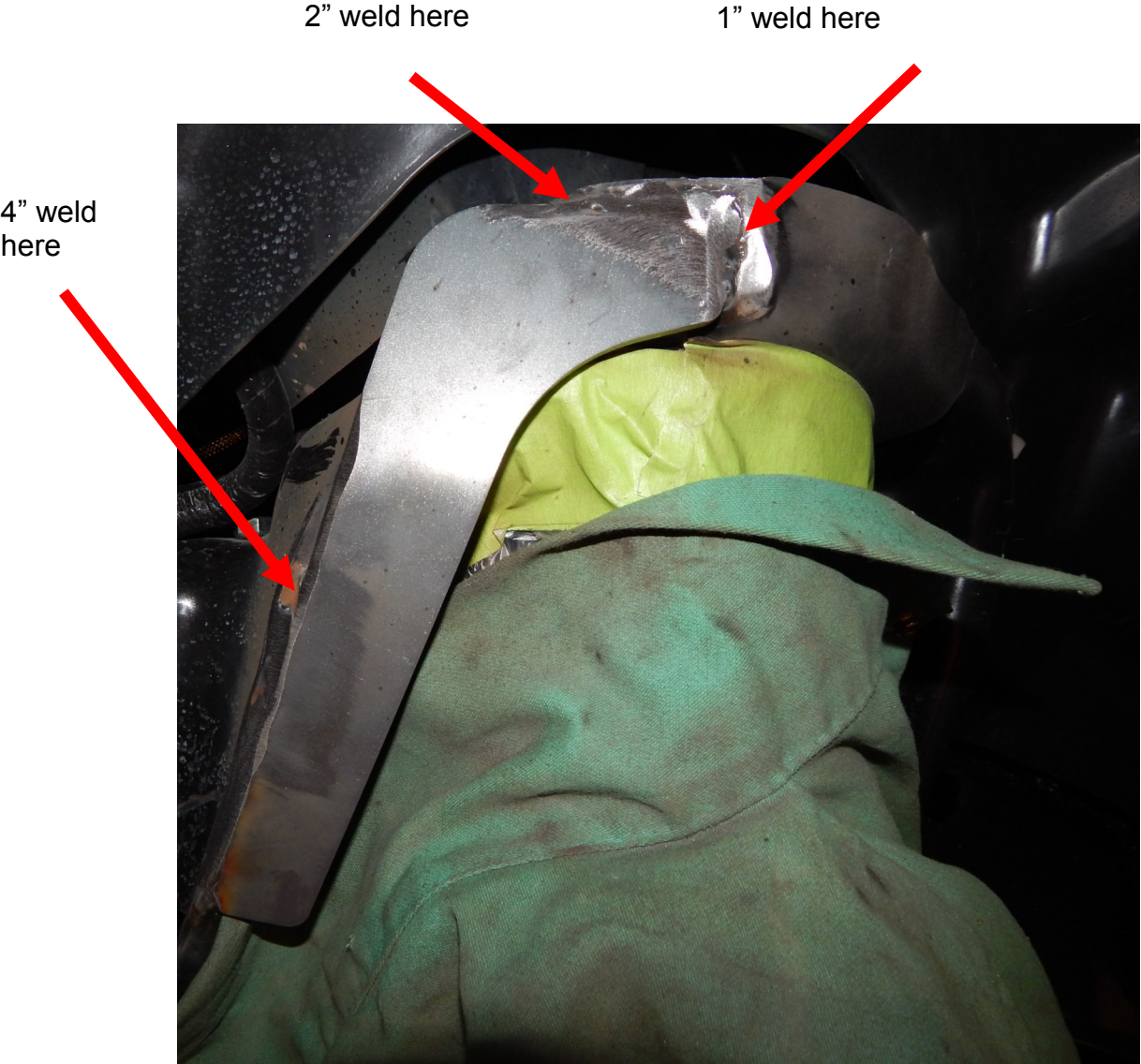



Ride height of air bag is between 7 1/2-8 1/2" measure here

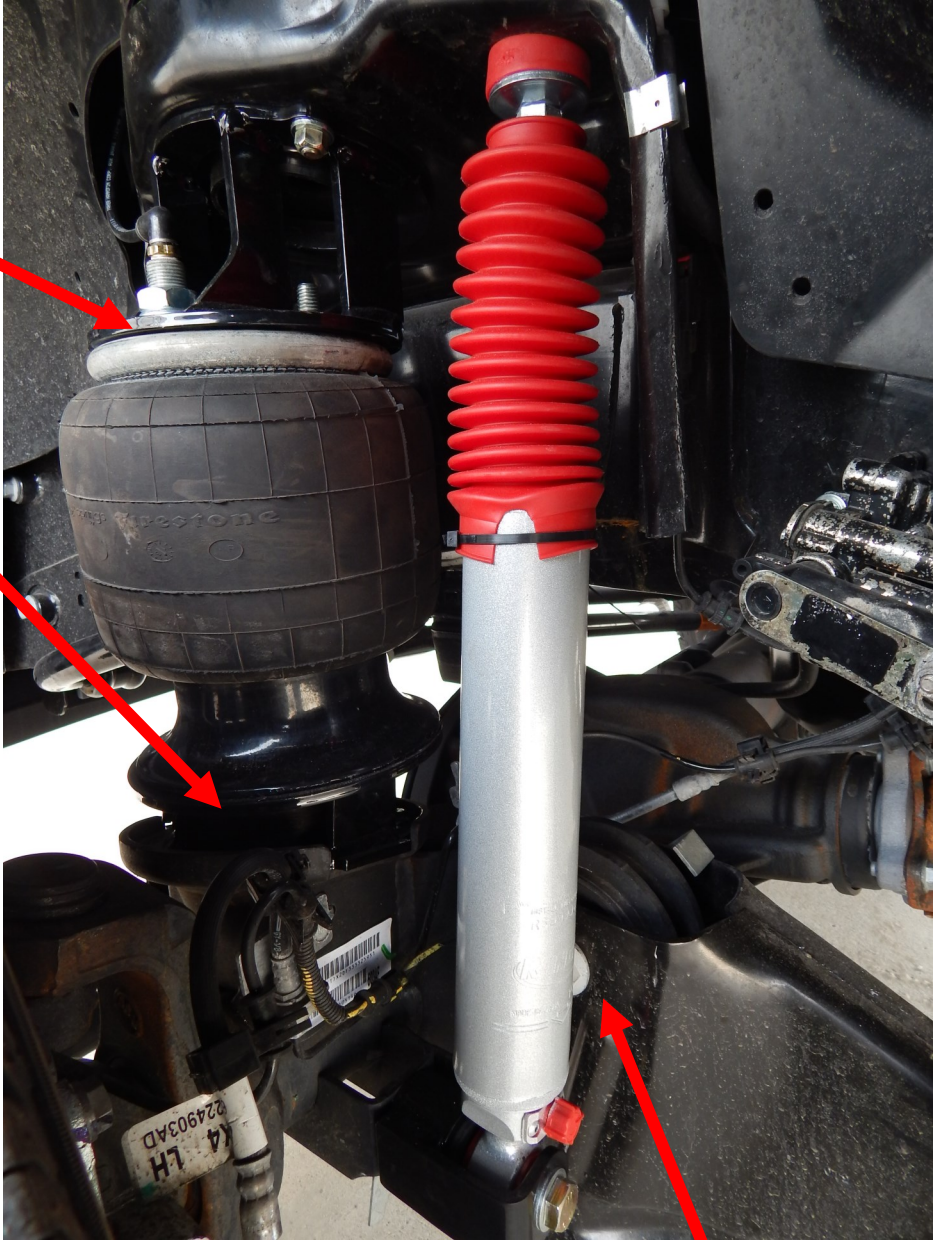

Don't forget to check clearance on the shock for clearance with this bolt.

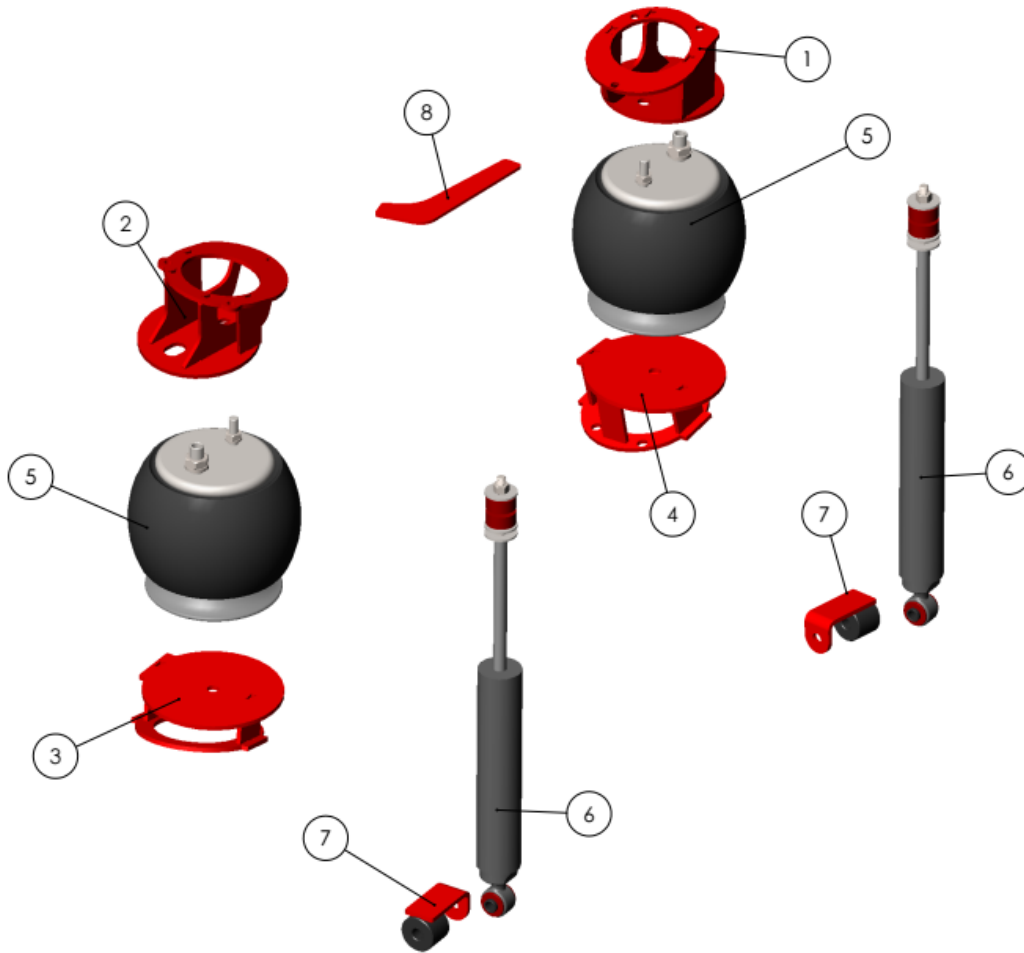

ITEM NO.	PART NUMBER	DESCRIPTION	QTY.
1	18361	(PS) Front Upper Bag Mount	1
2	18365	(DS) Front Upper Bag/Frame Mount	1
3	18269	(DS) Front Lower Bag Mount	1
4	18274	(PS) Front Lower Bag Mount 1" Lift	1
5	5323-1	Firestone 5323	2
6	Rancho-99043	99043	2
7	18378	Fox Remote Shock Mount	2
8	18436	Support Gusset	1

## Front sensor mounts (for ESLK4 control systems) (Optional)



Drivers



Passenger side

If you are installing an electronic control kit, use the provided metal sensor mounts to weld to the frame. The electronic sensor will then be bolted to the metal sensor mount. Now drill and tap the trailing arm 5/16-18" and fasten the ball stud. If you are doing the Air Lift sensor, you will want to

